

## WEEK AT A GLANCE

### SUNDAY, MARCH 7

Worship Services, Sanctuary, 9:00 & 11:00 a.m.  
Children's Worship, Central Complex, 9:00 & 11:00am  
Moss Reception, Grace Café, FLC, 10:00am  
Fidelis Class, Rm. 301, 10:00am  
Wise CE Class, Rm. 106, 10:30am  
Men's Softball Meeting, FLC, Noon  
Shepherd's Hands Practice, Room 207, 4:00pm  
Hard Core, FLC, 6:00pm  
Preteen Small Group, CC, 6:00pm  
Ambassador Class, Room 105, 6:00pm  
Walker Small Group, Room 301, 6:00 pm

### TUESDAY, MARCH 9

Prayer & Praise, Rm. 301, 10:00am  
Prayer & Praise Game Night, Central Complex, 6:00 pm  
Church Board Meeting, Room 301, 7:00 pm

### WEDNESDAY, MARCH 10

Mom's in Touch, Rm. 105, 9:30am  
HOPE Ministry Team, Rm. 106, 5:30pm  
Praise Team Rehearsal, Sanctuary, 5:45pm  
Adult Choir, Sanctuary, 6:45pm  
Adult Bible Study, Fenster House, 6:45pm  
Esther Bible Study, Rm. 301, 6:45pm  
Children's Christian Education, 6:45pm  
ATM Youth Ministry, FLC, 6:45pm  
ESL Classes, SCS, 7:00p.m.  
Praise Band Rehearsal, Sanctuary, 7:45pm

### THURSDAY, MARCH 11

Financial Peace Class, SCS, 6:00pm  
Celebrate Recovery Monthly Event, Meal 6:30 pm  
Large Group, Sanctuary, 7:00pm  
Women's Open Share, Room 105, 8:00pm  
Men's Open Share, Room 106, 8:00pm

## About Shepherd Naz

We are Everyday People Loving God, Loving Others as we Welcome, Worship, Grow and Serve. What does this mean?

**Welcome:** Loving guests like family and family like guests.

**Worship:** Choosing to encounter God right where we are.

**Grow:** Taking the next step in our journey with Christ.

**Serve:** Asking "How may I help?"

## Nurseries & Children's Church

Our caring volunteers and Children's workers minister to infants through 4th graders during both services.

\* Infant Nursery (0-18 months): Room 202

\* Wee Walkers (18 months – 3): Room 204

\* Leaps & Bounds (Preschool – K)

\* 1st – 4th Grade: Central Complex

## Grace Café

Food, fellowship, and friendly faces... Stop by the Family Life Center to enjoy the Grace Café from 10:15-11:00 on Sunday mornings.

## Welcome Visitors

We are so glad that you are here. We hope that Shepherd Church is a place where you will find everyday people loving God, and loving others. Wherever you are on your journey, our desire is that you will encounter God's peace with us today!

Please take a moment to complete the mocha-colored Guest/Member Registration card in your bulletin, and place it in the offering plate when it is passed. We would love to have a record of your visit with us today.

## Schedule of Services

Sunday Morning Worship, 9 & 11 a.m.

Children's Worship Services, 9 & 11 a.m.

Small Group Leader Training, Sundays 6 p.m.

Senior Prayer & Praise, Tuesday 10 a.m.

Christian Education, Wednesday 6:45 p.m.  
*(includes classes for all ages, Choir, Praise Band and vocal rehearsals.)*

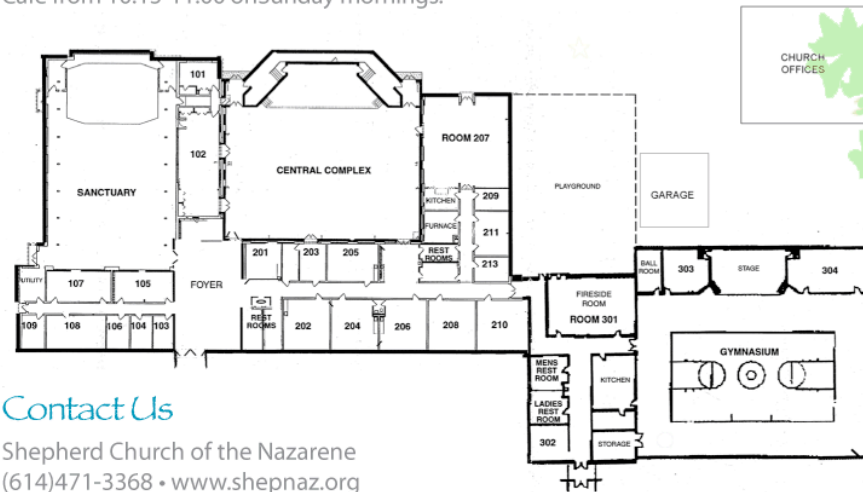

## Contact Us

Shepherd Church of the Nazarene  
(614)471-3368 • www.shepnaz.org

Shepherd Christian School  
(614)471-0859 • www.shepherdchristian.org

Little Lambs Children's Center (614)471-9269

  
**Shepherd Church**  
OF THE NAZARENE

425 South Hamilton Road, Gahanna OH 43230  
(614)471-3368 • www.shepnaz.org

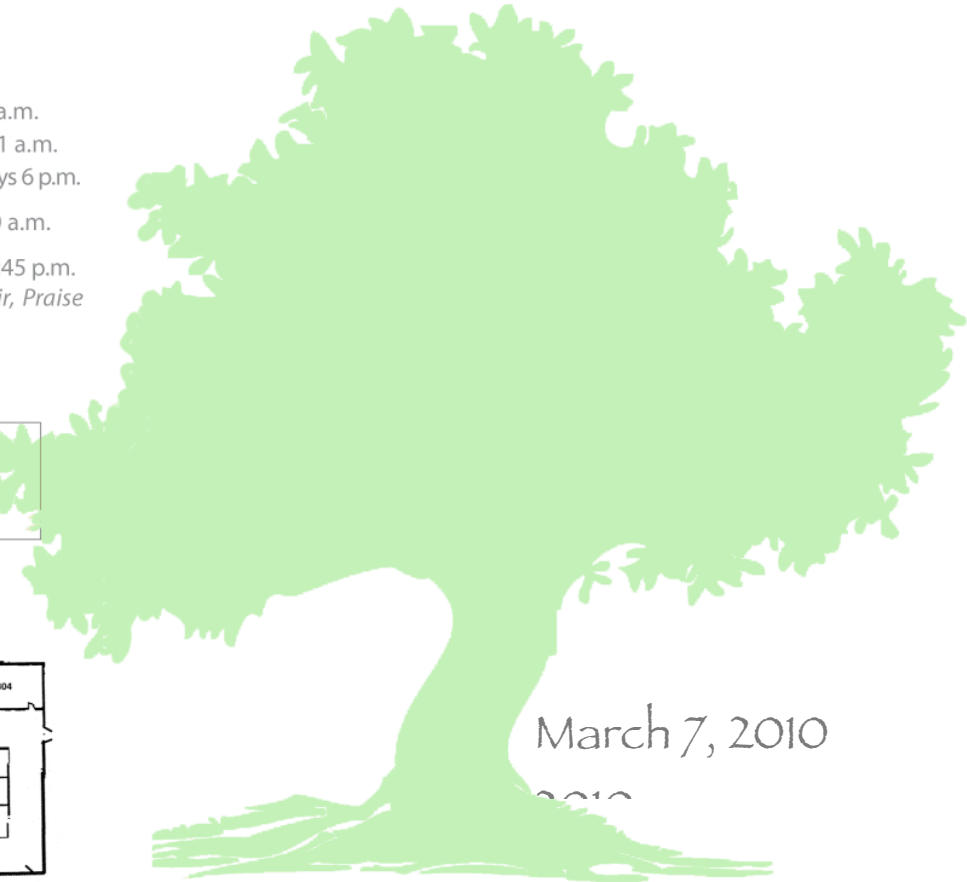

*Everyday People Loving God, Loving Others*

*as we Welcome, Worship, Grow and Serve*

## MINISTRY HIGHLIGHTS

### EASTER CHOIR

If you would like to be part of the Easter Choir, join us on Wednesdays in March at 6:45 p.m. in the Sanctuary.

### TONY MOSLEY SPEAKING

Tony Mosley will speak at Celebrate Recovery on March 11. Join us at 6:30 for the meal or at 7:15 for worship and the speaker. Open to adults 18 years and older. Contact Nancy Skaggs (471-3368) to RSVP.

### COLUMBUS EAST NMI ZONE RALLY

Columbus East NMI Zone Rally is March 18 at 7:00 p.m. at Pickerington Church of the Nazarene (11775 Pickerington RD). Speakers are Daniel and Brenda Hopkins missionaries from Dominica.

### WALK OR RUN FOR A GOOD CAUSE

Plan to join our Celebrate Recovery team in walking or running the Commit to Be Fit 5K or ½ Marathon on Saturday, May 1<sup>st</sup>. Stop by the CR table in the foyer for information.

### EASTER FLOWERS

To remember a loved one with an Easter flower, pick up an order form from the Ministry Counter and drop it along with payment in the black box or the offering plate. Flowers are \$6 each.

### MUSIC MINISTRY OPPORTUNITIES

The Worship Arts Team is looking for people who sing or play an instrument (bass/ acoustic guitar, drums, strings, trumpet, trombone, piano/keyboards), and have a heart for worship. Contact Amy Fisher (471-3368).

### TECH/MEDIA OPPORTUNITIES

The Media Team is looking for experienced volunteers to create media and PowerPoint presentations and team members who can run PowerPoint for Sunday worship. Contact Amy Fisher.

The Sound Team is looking for *experienced* volunteers interested in running sound for Sunday morning worship services and other events. Contact Amy Fisher or Bob Stephenson (778-3306).

## WOMEN'S MINISTRIES

### WARRIOR CHIX

Our next Warrior Chix gathering will be Tuesday, March 16 at 6:30 p.m. in Room 301. Kim Flynn from Lower Lights Ministries will be our speaker. A women's health moment, book report & refreshments will be part of the evening. Sign up at the ministry counter. Indicate if you need childcare.

### L.A.F.F.

Ladies Appreciating Food and Fellowship will meet Monday, March 22 at 6:00 p.m. at Abuelos Mexican Restaurant at Easton Town Center. Sign up at the Ministry Counter.

### CALLING ALL CONNOISSEURS

Share with us your favorite family recipes for our up-coming cook book. Written copies may be given to Sharon Terrell, Jan Partlow Penny Bonham or email Sharon at smtcats@sbcglobal.net.

## PRAYER and PRAISE

### PRAYER & PRAISE GAME NIGHTS

Prayer & Praise cornhole-game nights Tuesday, March 9, 6:00-8:00 in the Central Complex and Saturday, March 13, 3:00-5:00 in the Central Complex.

## CHILDREN'S MINISTRY

### QUIZZING UPDATE

It's "Hug a Bible Quizzer" Sunday! Our quizzers, wearing navy polo's, competed yesterday in the zone finals at Pataskala. Our teens will compete in district finals on March 20<sup>th</sup> in Chillicothe.

### CHILDREN'S SPRING MUSICAL

1<sup>st</sup>-6<sup>th</sup> graders will present a musical on Sunday, April 25. Practice CDs(\$10) available. Scholarships are available.

### FUTURE DATES

Baptism - April 4.  
Let's Be Real! - March 28, April 18, May 23.  
EGGstravaganza - April 3.  
Preteen Mission Trip - July 7-10.  
District Children's Camp - July 26-30.  
6<sup>th</sup> Grade Retreat - Aug. 3-5.

## YOUTH MINISTRY

### YOUTH MISSION FUNDRAISER

You're invited to **A Dinner and a Show FUNDraiser** on March 20 in the FLC at 5:30 p.m. featuring a talent show, chili cookoff, silent auction and homemade baked goods. Cost \$5 adults, \$3 children under 12 or \$20 max for entire family. Proceeds benefit the youth mission trip to Louisiana. Sign up in the foyer to help or donate items. Contact Steve or Brenda Oty, Sherryl Curnutte or Steve Nally.

### PARENTS OF TEENS/PRETEENS

Janet Walker's small group for parents of preteens and teens begins tonight at 6:00 p.m. in Room 301.

## SCS and LLCC

### MARKET DAY

Market Day pickup is April 6<sup>th</sup>. Brochures available at the Ministry

Counter or visit [www.marketday.com](http://www.marketday.com).

### OPEN HOUSE, MARCH 16

Open House for Little Lambs Children's Center and Shepherd Christian School will be March 16, 6:00-7:30 p.m. Tour our buildings, talk to some staff and receive more information about our daycare, preschool, summer care, school and extended care. Our programs are for children ages 6 weeks to 5<sup>th</sup> grade.

### SUMMER CARE AND FALL ENROLLMENT

Little Lambs Children's Center and Shepherd Christian School are now enrolling for summer and fall. Summer program begins June 7 and ends August 20. Many ex-citing learning experiences and activities are planned. Enroll for summer care by April 10 and receive last summer's rates. Visit us online at [www.shepherdchristianschool.org](http://www.shepherdchristianschool.org).

## STEWARDSHIP

	<u>2/28/10</u>	<u>YTD</u>
Attendance	576	591
CE/Sm Group	495	339
Tithes Needed	\$16,825	\$891,721
Tithes Received	\$17,602	\$839,973
Faith Promise Needed	\$1,519	\$80,519
Faith Promise Received	\$871	\$56,243

New Day Rebuilders	<u>2/28/10</u>	<u>YTD</u>
Participants		176
Dollars Committed		\$184,200
<b>RECEIPTS</b>	<u>02/28/10</u>	-
New Day Receipts	\$4,123	\$131,311

## PRAYER REQUESTS

You can leave prayer requests 24 hours a day by calling the Shepherd Prayer Line at 471-3368, ext 6.

- Ken Hughes and family in the passing of Marollyn.
- John Dandria, stroke.
- Jonathan Willis, emergency appendectomy.
- Paul Ondera recovering from accident.
- Joy Duty kidney problems.
- Ruby Mills, improving.
- Grace Tanner, fell and suffered a broken arm.
- Fred Oty - new chemo regimen.
- McKenzie Parkinson, Jeff White, Dee Horner, Joanne Feen, Lisa Canfield recovering from surgery.
- Health concerns: Bonnie Schrills, Joe Wilson, Margaret Carpenter, Betty Tolbert, Betty Oyler.
- Those without work and/or struggling financially.
- Those dealing with cancer: Jack Carsey, Eric Anderson, Jeneil, Larry Toler, Jim Wietrzkowski, Fred Oty, Connie Hansgen, Starlene Hall, Charles Wise, Jody Armstrong VanOss, Earl Weitlick, Linda Williams, Paula Winkler, David Kohr, Wayne Saunders, Barney Barnes, Mary Yerian, David Rafferty, Kenneth Sweet, Mike Ondera, Bobby Wibblesman, Maria Nader, Sherry Byrd's brothers, Michale Craft, Sharon Rapp, Sharon Ondera.
- Shut-ins: Dianne Bol, Dwight Shirey, Rosie Downs, Mildred Orr, Edith Noble, Edna Everhart, Juanita McCarty, Betty Howdysheal, Art Morin, Harold & Dorothy Bennett, Pam Skoda, Rhonda Lucas, Juanita Robinson, Rutherford Wright.