

WEEK AT A GLANCE

SUNDAY, FEBRUARY 21

Worship Services, Sanctuary, 9:00 & 11:00 a.m.

Children's Worship, Central Complex, 9:00 & 11:00am

Grace Café, Nugent Retirement, FLC, 10:00am

Fidelis Class, Rm. 301, 10:00am

Wise CE Class, Rm. 106, 10:30am

Small Group Luncheon, Rm 301, Noon.

Let's Be Real!, Central Complex, Noon.

Shepherd's Hands Practice, Central Complex, 4:00pm

Valentine Banquet, FLC, 5:00pm

Preteen Small Group, CC, 6:00pm

MONDAY, FEBRUARY 22

L.A.F.F. to Hickory House, 6:00pm

TUESDAY, FEBRUARY 23

Prayer & Praise, Rm. 301, 10:00am

Sr. Adult Cornhole/Game Night, CC, 6:00pm

Warrior Chix, Rm. 301, 6:30pm

WEDNESDAY, FEBRUARY 24

Mom's in Touch, Rm. 105, 9:30am

Praise Team Rehearsal, Sanctuary, 5:45pm

Adult Choir, Sanctuary, 6:45pm

Adult Bible Study, Rm 105, 6:45pm

Esther Bible Study, Rm. 301, 6:45pm

Children's Christian Education, 6:45pm

ATM Youth Ministry, FLC, 6:45pm

ESL Classes, SCS, 7:00p.m.

Praise Band Rehearsal, Sanctuary, 7:45pm

THURSDAY, FEBRUARY 25

Financial Peace Class, SCS, 6:00pm

Celebrate Recovery Large Group, Sanctuary, 7:00pm

Women's Open Share, Room 105, 8:00pm

Men's Open Share, Room 106, 8:00pm

About Shepherd Naz

We are Everyday People Loving God, Loving Others as we Welcome, Worship, Grow and Serve. What does this mean?

Welcome: Loving guests like family and family like guests.

Worship: Choosing to encounter God right where we are.

Grow: Taking the next step in our journey with Christ.

Serve: Asking "How may I help?"

Nurseries & Children's Church

Our caring volunteers and Children's workers minister to infants through 4th graders during both services.

* Infant Nursery (0-18 months): Room 202

* Wee Walkers (18 months – 3): Room 204

* Leaps & Bounds (Preschool – K)

* 1st – 4th Grade: Central Complex

Grace Café

Food, fellowship, and friendly faces... Stop by the Family Life Center to enjoy the Grace Café from 10:15-11:00 on Sunday mornings.

Welcome Visitors

We are so glad that you are here. We hope that Shepherd Church is a place where you will find everyday people loving God, and loving others. Wherever you are on your journey, our desire is that you will encounter God's peace with us today!

Please take a moment to complete the mocha-colored Guest/Member Registration card in your bulletin, and place it in the offering plate when it is passed. We would love to have a record of your visit with us today.

Schedule of Services

Sunday Morning Worship, 9 & 11 a.m.

Children's Worship Services, 9 & 11 a.m.

Small Group Leader Training, Sundays 6 p.m.

Senior Prayer & Praise, Tuesday 10 a.m.

Christian Education, Wednesday 6:45 p.m.
(includes classes for all ages, Choir, Praise Band and vocal rehearsals.)

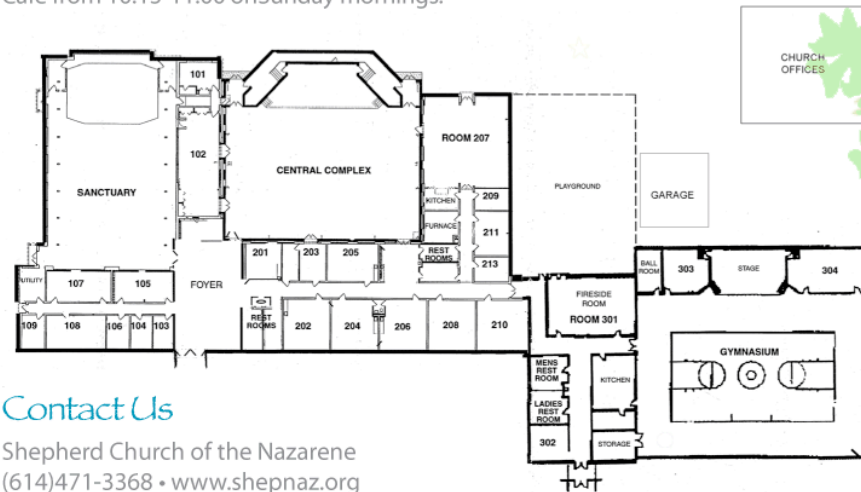

Contact Us

Shepherd Church of the Nazarene
(614)471-3368 • www.shepnaz.org

Shepherd Christian School
(614)471-0859 • www.shepherdchristian.org

Little Lambs Children's Center (614)471-9269

Shepherd Church
OF THE NAZARENE

425 South Hamilton Road, Gahanna OH 43230
(614)471-3368 • www.shepnaz.org



Everyday People Loving God, Loving Others

as we Welcome, Worship, Grow and Serve

MINISTRY HIGHLIGHTS

GUEST/MEMBER REGISTRATION

If you're visiting with us today, Welcome! Please fill out a green Guest/Member Registration form located in the pew. After the service, one of our pastors will be available to greet you in the Welcome Room located behind the Sanctuary.

AMBASSADOR CLASS

The Ambassador Class will not meet this evening due to the Valentine Banquet.

NUGENT RETIREMENT RECEPTION

Join us today during Grace Cafe as we honor Gerri Nugent on her upcoming retirement.

CHURCH BOARD ELECTIONS

Today and Feb. 28 we will hold elections for the 2010-2011 Church Board. All members of Shepherd Church are eligible to vote in this election.

BASKETBALL AWARDS

Volunteers are needed to help with set up, clean up and to serve as greeters for the Basketball Awards on Sunday, Feb. 28th. Contact Pastor Julie (774-6062).

BENEFIT FOR CONNIE HANSGEN

There will be an all you can eat pancake breakfast on Saturday, March 6 from 8:30-11:30 a.m. at Licking Heights High School (4000 Mink Street, entrance on Cable RD) to benefit Connie Hansgen in her fight against breast cancer. Chris Cakes will be there "flippin" pancakes and there will be a silent auction. Cost \$6 per person.

SOFTBALL MEETING

Those interested in playing softball this summer meet in the Family

Life Center on Sunday, March 7th following second service. Contact Jamey Keys (648-6177) for more information.

WALK OR RUN FOR A GOOD CAUSE

Want to get in shape? Plan to join our Celebrate Recovery team in walking or running the Commit to Be Fit 5K or 1/2 Marathon on Saturday, May 1st. Contact Nancy Skaggs (471-3368, ext. 24) or stop by the CR table in the foyer for more information.

DELEGATES NEEDED

Delegates (you must be a member of Shepherd Church) are needed to represent Shepherd at the NMI Convention (April 21-22) and District Assembly (April 23-24) at the Grove City Church of the Nazarene. Sign up at the Ministry Counter.

CONGRATULATIONS ALLISON

Congratulations to Allison Mushett (a volunteer in our WeeWalker room) who was honored by Kroger for winning 2nd place in the Special Olympics State and City finals. Way to go Allison!

WOMEN'S MINISTRIES

WARRIOR CHIX RESCHEDULED

Warrior Chix meeting is rescheduled for Tuesday, February 23 at 6:30 p.m. in Room 301. Speaker will be Jill Barber. A book review, secret sister reveal/draw and refreshments will round out the evening. All ladies invited. Child care provided (\$2 per child). Please sign up at the Ministry Counter and indicate if you need child care.

SCS and LLCC

LITTLE LAMB'S SUMMER PROGRAM

Little Lambs Children's Center will have summer care available from June 7 to August 20. Call 471-0859 for more information.

PRAYER & PRAISE

WANT TO HAVE SOME FUN?

Senior Adults will enjoy an evening of games and corn hole on Tuesday, February 23 at 6:00 p.m. in the Central Complex. All Sr. adults welcome.

CHILDREN'S MINISTRY

LET'S BE REAL...

Today for all 4th-6th graders, lunch, Bible study and an activity. Cost: \$10. Bring your Bible. Parent drivers needed. Contact Pastor Julie (774-6062).

CHILDREN'S SPRING MUSICAL

1ST-6TH graders will present a musical on Sunday, April 25. Practices will be during children's worship. Practice CDs are available. Each family involved is asked to pitch in \$10 for your CD and expenses. Scholarships are available. Tryouts will be Sunday, Feb. 28 during children's worship.

FUTURE DATES

Baptism - April 4.
Let's Be Real! - March 28, April 18, May 23.
EGGstravaganza - April 3.
Preteen Mission Trip - July 7-10.
District Children's Camp - July 26-30.
6th Grade Retreat - Aug. 3-5.

YOUTH MINISTRY

YOUTH MISSION FUNDRAISER

The youth department is holding a fundraiser on March 20th for their Mission trip to Lake Charles, Louisiana. WANTED: New and like new items, large and small to be auctioned off at the fundraiser.

Contact Brenda Oty (476-9293 brendaoty@gmail.com) or Sherryl Curnutte (471-5296).

PARENTS OF TEENS/PRETEENS

Janet Walker is starting a new small group on Sunday, March 7th for parent of preteens and teens. The group will meet on Sunday nights at the church (location to be announced) from 6:00 to 7:15. For more information contact Janet at 276-8313.

STEWARDSHIP

	<u>2/14/10</u>	<u>YTD</u>
Attendance	499	592
CE/Sm Group	415	332
Tithes Needed	\$16,825	\$858,071
Tithes Received	\$12,930	\$809,949
Faith Promise Needed	\$1,519	\$77,481
Faith Promise Received	\$1,396	\$54,569

New Day Rebuilders	2/14/10	YTD
Participants		176
Dollars Committed		\$184,200
RECEIPTS	<u>02/14/10</u>	-
New Day Receipts	\$2,288	\$125,503

PRAYER REQUESTS

You can leave prayer requests 24 hours a day by calling the Shepherd Prayer Line at 471-3368, ext 6.

- Dwight & Susie Shirey health concerns.
- Robert Atchely, Kobacker House.
- Joy Duty kidney problems.
- Ruby Mills suffered a stroke.
- Mackenzie Parkinson at Children's.
- Joy Bower, recovering from oral surgery.
- Doug Rager, back injury.
- J.W. Dawson, Fran Sperry, Donna Pest, recovering from surgery.
- Health concerns: Dottie Ishler, Bonnie Schrilla, Abe Shroufe, Joe Wilson, Margaret Carpenter, Betty Tolbert, Betty Oyler.
- Those without work and/or struggling financially.
- Those dealing with cancer: Jack Carsey, Eric Anderson, Jeneil, Larry Toler, Jim Wietrzkowski, Fred Oty, Connie Hansgen, Starlene Hall, Charles Wise, Sam Bish, Jody Armstrong VanOss, Earl Weitlick, Marollyn Hughes, Linda Williams, Paula Winkler, David Kohr, Wayne Saunders, Barney Barnes, Mary Yerian, David Rafferty, Kenneth Sweet, Mike Ondera, Bobby Wibblesman, Maria Nader, Sherry Byrd's brothers, Michale Craft, Sharon Rapp, Sharon Ondera.
- Shut-ins: Dianne Bol, Dwight Shirey, Rosie Downs, Mildred Orr, Edith Noble, Edna Everhart, Juanita McCarty, Betty Howdysheal, Art Morin, Harold & Dorothy Bennett, Pam Skoda, Rhonda Lucas, Juanita Robinson, Rutherford Wright.